

面積求積図 (改修後) 1:200

1. 申請建物

番号	計算式			建築面積・延床面積 (㎡)
	X (m)	Y (m)	㎡	
①	4.55 ×	7.28 =	33.1240	347.9103
②	1.82 ×	0.91 =	1.6562	
③	31.85 ×	7.28 =	231.8680	
④	1.82 ×	1.82 =	3.3124	
⑤	7.28 ×	9.1 =	66.2480	
⑥	1.82 ×	0.91 =	1.6562	
⑦	4.55 ×	1.82 =	8.2810	
⑧	1.82 ×	0.303 =	0.5515	
⑨	2.06 ×	0.455 =	0.9373	
⑩	0.303 ×	0.91 =	0.2757	
A	1.365 ×	0.91 =	1.2422	95.9677 →95.97
B	4.55 ×	1.82 =	8.2810	
C	0.91 ×	3.64 =	3.3124	
D	0.91 ×	3.64 =	3.3124	
E	欠番			
F	1.5 ×	6.37 =	9.5550	
G	1.197 ×	1.82 =	2.1785	
H	1.5 ×	8.19 =	12.2850	
I	10.22 ×	5.46 =	55.8012	

2. 既存倉庫

2.73 × 3.64 =	9.9372
	→9.94

3. 既存倉庫 (申請履歴なし)

1.8 × 2.2 =	3.9600
-------------	--------

4. 既存倉庫 (申請履歴なし)

3.73 × 1.3 =	4.8490
	→4.85

建築面積・延床面積

1	2	3	4	合計
443.8780	+	9.9372	+	3.9600
			+	4.8490
				= 462.6242
				→462.63

建蔽率・容積率

462.6242 ÷ 1091.38 =	0.42389	42.39%
----------------------	---------	--------

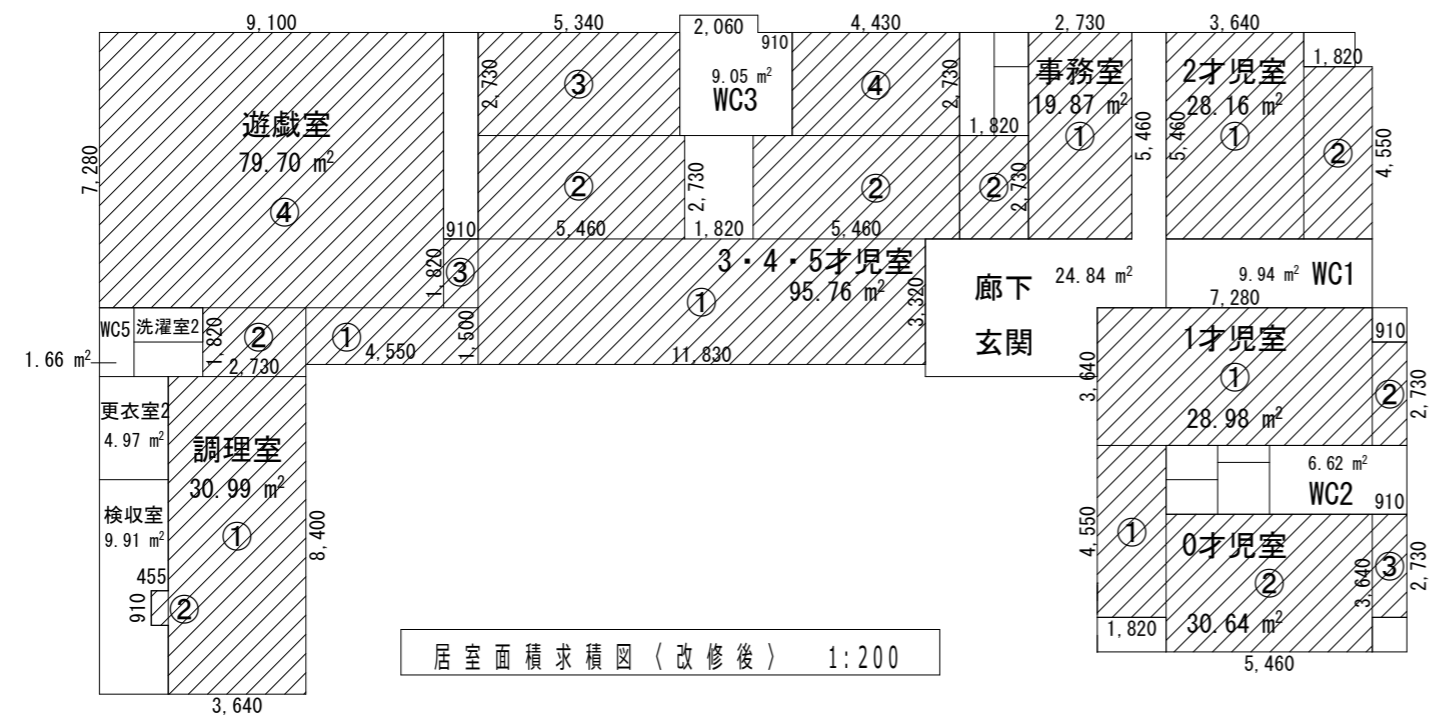

居室面積求積図 (改修後) 1:200

居室求積表

室名	番号	計算式			面積 (㎡)
		X (m)	Y (m)	箇所数 ㎡	
0才児室	①	4.5500 ×	1.8200 =	8.2810	30.6397
	②	5.4600 ×	3.6400 =	19.8744	
	③	0.9100 ×	2.7300 =	2.4843	
1才児室	①	3.6400 ×	7.2800 =	26.4992	28.9835
	②	0.9100 ×	2.7300 =	2.4843	
2才児室	①	5.4600 ×	3.6400 =	19.8744	28.1554
	②	4.5500 ×	1.8200 =	8.2810	
3・4・5才児室	①	11.8300 ×	3.3200 =	39.2756	95.7593
	②	5.4600 ×	2.7300 × 2 =	29.8116	
	③	5.3400 ×	2.7300 =	14.5782	
	④	4.4300 ×	2.7300 =	12.0939	
遊戯室	①	1.5000 ×	4.5500 =	6.8250	79.6978
	②	1.8200 ×	2.7300 =	4.9686	
	③	1.8200 ×	0.9100 =	1.6562	
	④	9.1000 ×	7.2800 =	66.2480	
事務室	①	2.7300 ×	5.4600 =	14.9058	19.8744
	②	1.8200 ×	2.7300 =	4.9686	
調理室	①	3.6400 ×	8.4000 =	30.5760	30.9901
	②	0.4550 ×	0.9100 =	0.4141	

